

- ALL ACTIVITIES TAKE PLACE IN ALL PUBLIC AREAS**
- RED DASHED LINE DENOTES SITE BOUNDARY
  - GREEN LINE DENOTES AREA ACCESSIBLE BY CHILDREN (EXCLUDING BOILER STORE)
  - BLUE LINE DENOTES AREA FOR SALE OF ALCOHOL FOR OFF-SITE CONSUMPTION.

- FIRE LEGEND**
- SD SMOKE DETECTOR
  - EMERGENCY LIGHT
  - △ CARBON DIOXIDE EXTINGUISHER
  - note - 24 HOUR CCTV IN OPERATION (SHOP AREA)

**OCCUPANCY (SHOP)**  
 MAXIMUM OCCUPANCY BASED ON AREA INDICATED:  
 12 public + 1 staff  
**TOTAL OCCUPANCY: 13**

**16000 approximately**

**GENERAL NOTES**

FOR CONSTRUCTION PURPOSES DO NOT SCALE. VERIFY ALL DIMENSIONS AND LEVELS ON SITE. CONFIRM ALL SET POINTS AND DIMENSIONS.

SMOKE DETECTOR AND CARBON DIOXIDE EXTINGUISHERS TO BE INSTALLED IN ACCORDANCE WITH THE SPECIFICATIONS.

THIS DRAWING TO BE READ IN CONJUNCTION WITH ALL RELEVANT CONSULTANTS DRAWINGS AND MATERIALS AND WORKMANSHIP TO BE TO BE EXACT WITH STANDARDS AND CODES OF PRACTICE AND MANUFACTURERS' WRITTEN RECOMMENDATIONS WHERE APPLICABLE, UNLESS SPECIFICALLY NOTED OTHERWISE.

ALL WORKS TO BE EXECUTED WITH DUE CARE AND DILIGENCE SO AS NOT TO IMPAIR THE STABILITY OR INTEGRITY OF THE EXISTING STRUCTURE. THE CONTRACTOR SHALL BE RESPONSIBLE FOR OBTAINING ALL NECESSARY PERMITS AND APPROVALS FROM THE LOCAL AUTHORITY AND RELEVANT AGENCIES PRIOR TO COMMENCING WORK.

**REVDATE INTIS AMENDMENT**

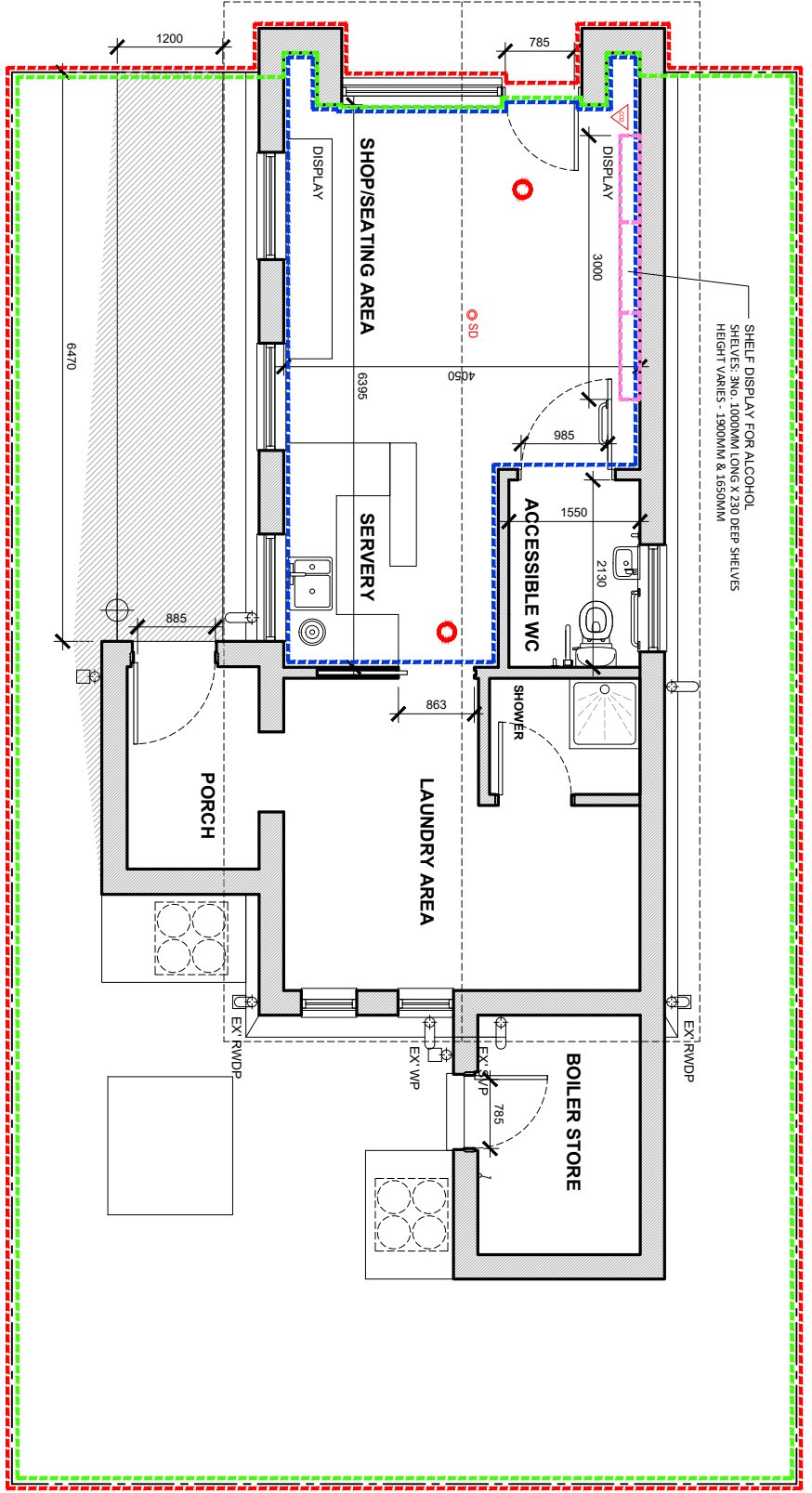

**GROUND FLOOR PLAN**

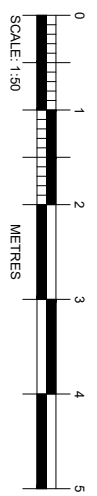

approximately  
8900

**DRAWING TITLE**  
**LICENSING PLAN LAYOUT**

PROJECT: LICENSING PLAN  
 LOCATION: SCARINISH PIER ROAD, ISLE OF TIRREH, PA77 6TN  
 CLIENT: MRS KATE MACLEOD  
 DATE: MAY 2021  
 SCALE: 1:50  
 DRAWN BY: EPM/ML/ldm  
 CHECKED BY: EPM/ML/ldm  
 JOB NO: 3073  
 DRAWING NO: L(25)01

